



LANGHOLZ WILSON ELLIS
Commercial Real Estate Services

For Lease - Hot Metal Plaza

1025 Lebanon Rd (Rt. 885)
West Mifflin, PA



- 18,000 sf
- 2 loading docks
- 2 drive-in doors
- 50' x 50' column spacing
- 24' clear ceiling height

For further information, contact:

Matthew Virgin, SIOR

(mvirgin@LWEre.com)

412-261-2200

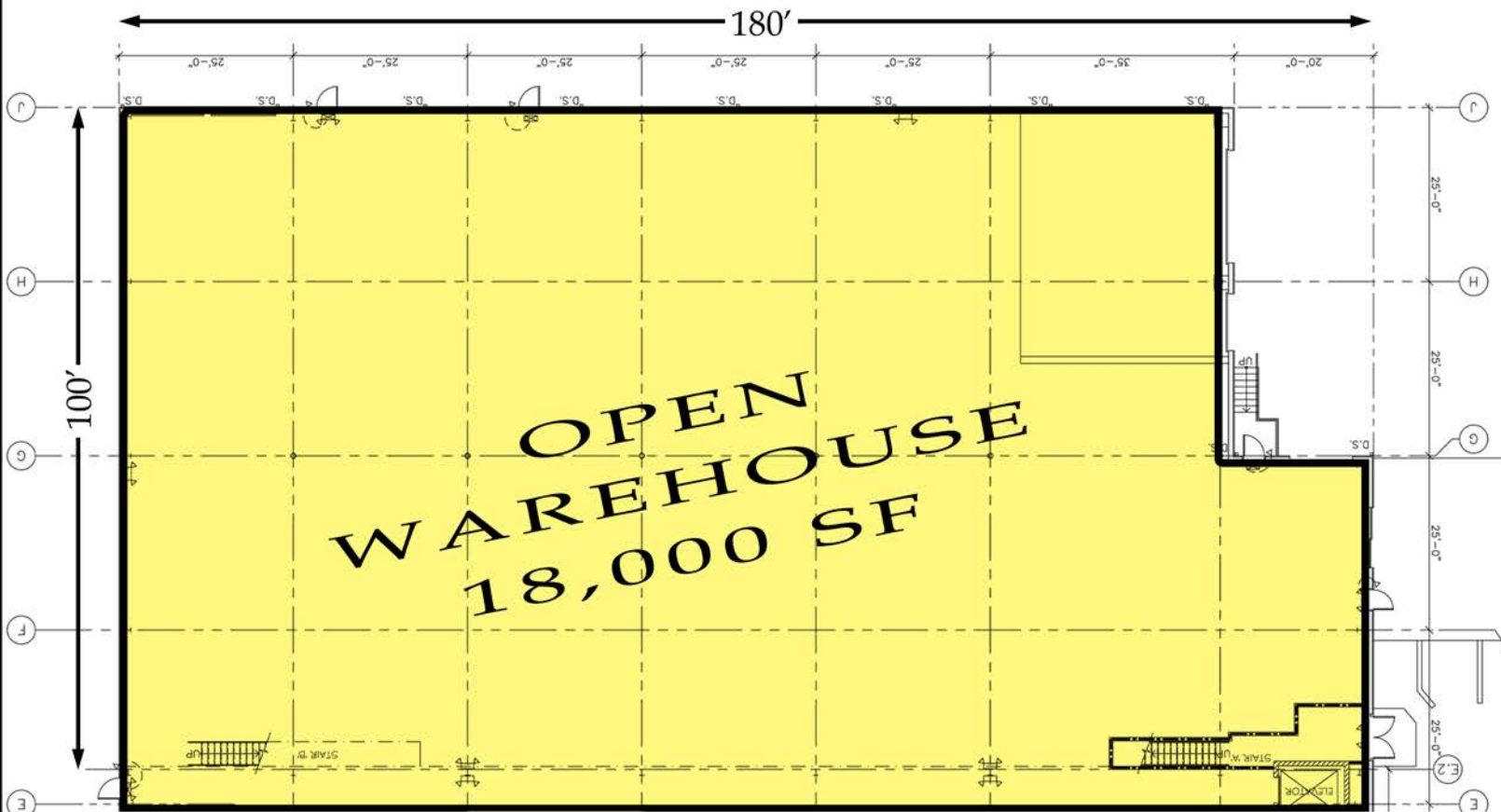

606 Liberty Avenue • Suite 300 • Pittsburgh, PA 15222 • Phone: 412-261-2200 • Fax: 412-261-2075 • www.LWEre.com

ALL INFORMATION FURNISHED REGARDING PROPERTY FOR SALE, RENTAL OR FINANCING IS FROM SOURCES DEEMED RELIABLE. NO REPRESENTATION IS MADE AS TO THE ACCURACY THEREOF, AND IT IS SUBMITTED SUBJECT TO ERRORS, OMISSIONS, CHANGE OF PRICE, RENTAL, OR OTHER CONDITIONS, PRIOR SALE LEASE, FINANCING OR WITHDRAWAL WITHOUT NOTICE. LANGHOLZ WILSON ELLIS, INC., WILL MAKE NO REPRESENTATION, AND ASSUME NO OBLIGATION, REGARDING THE PRESENCE OR ABSENCE OF TOXIC OR HAZARDOUS WASTE OR SUBSTANCES OR OTHER UNDESIRABLE MATERIAL ON OR ABOUT THE PROPERTY.

A MEMBER OF
CHAINLINKS
RETAIL ADVISORS



LANGHOLZ WILSON ELLIS
Commercial Real Estate Services

For Lease - Hot Metal Plaza

1025 Lebanon Rd (Rt. 885)
West Mifflin, PA

